



PROPERTY HIGHLIGHTS

- Public space renovation completed December 2025
- Missoula's premier hotel location alongside the beautiful and scenic Clark Fork River
- Within walking distance to Missoula's vibrant downtown scene
- New On The Fly dining outlet offering quick bites and espresso as well as Edgewater gear
- Updated, re-imagined outdoor pool including spacious, new hot tub
- Enhanced and upgraded Fitness Center
- 171 Guest Rooms and Suites
- On-site, riverside dining at FINN
- Spacious Ballroom with seating for 300 guests
- Beautifully appointed Boardroom featuring views of the Clark Fork River and seating for 12
- Easily accessible from Interstate 90 and directly across the river from the University of Montana

The Edgewater stands as a landmark along the Clark Fork River—a place where travelers and locals gather to experience the rhythm of the water, the pulse of downtown, and the untamed beauty of Montana. Now, re-imagined for the modern traveler, our thoughtfully redesigned spaces offer an experience where nature, culture, and hospitality flow together.

Whether you're casting a fly at sunrise, unwinding with a curated selection of Montana's finest spirits, or taking in the river's golden glow from your private balcony, every moment here is designed to immerse you in the soul of Missoula.

**COME, STAY, AND LET THE
RIVER MOVE YOU FORWARD.**

100 Madison Street | Missoula, MT 59802
406.728.3100 | 406.728.2530
tapestrycollection.com/edgewatermissoula

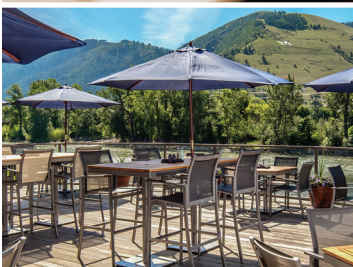
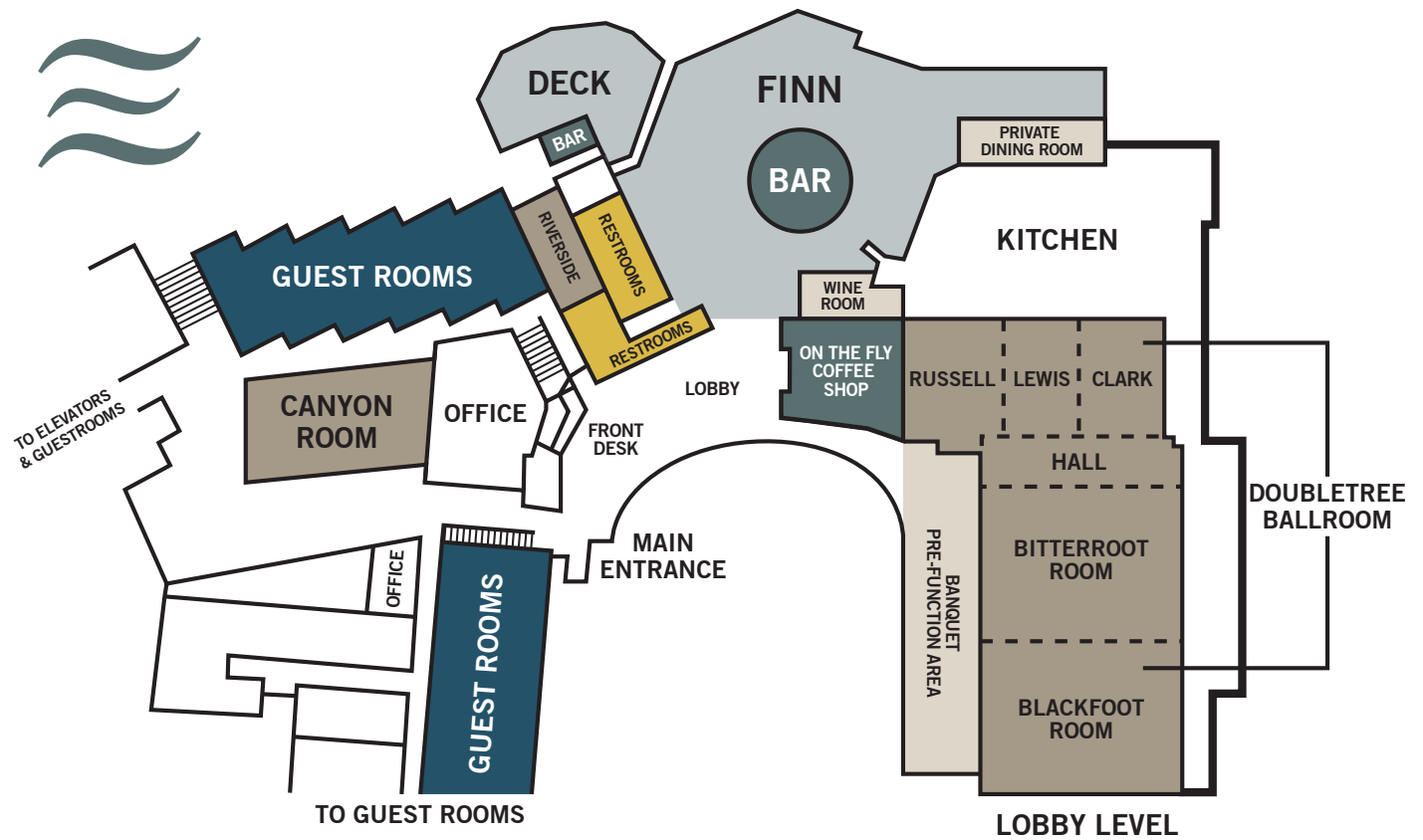

Meeting Room	Dimensions	Sq Ft	Rounds	Theatre	Classroom	Conference	U-Shape
Entire Ballroom*	51' x 117'	6363	400	550	400	-	-
BBLC	51' x 117'	5670	350	500	350	-	-
Bitterroot/RLC	51' x 63'	4374	250	400	250	-	-
Bitterroot/Blackfoot	51' x 78'	3978	200	450	200	-	-
Bitterroot/Hall	51' x 45'	2295	130	200	130	-	-
Bitterroot/Blackfoot/Hall	51' x 84'	4284	220	470	220	-	-
Bitterroot/LC	51' x 78'	3681	200	300	200	-	-
Bitterroot	51' x 39'	1989	90	180	90	40	40
Blackfoot	51' x 39'	1989	90	180	90	40	40
Russell/Lewis/Clark	63' x 33'	2079	140	190	110	40	40
Lewis/Clark	42' x 33'	1386	80	130	60	30	30
Russell/Lewis	42' x 33'	1386	80	130	60	30	30
RLC/Hall	63' x 39'	2385	160	210	130	40	40
Lewis/Clark/Hall	42' x 39'	1692	100	150	80	30	30
Hall	51' x 6'	306	20	20	20	15	15
Pre-Function Space	70' x 12'	-	-	-	-	-	-
Clark	21' x 33'	693	40	60	30	15	15
Lewis	21' x 33'	693	40	60	30	15	15
Russell	21' x 33'	693	40	60	30	15	15
Canyon	38' x 20'	760	50	75	40	20	20
Riverside	19' x 13'	247	-	-	-	15	-
Wine Room	Max Capacity: 8 guests						
Private Dining Room	Max Capacity: 24 guests						

*BB, RLC & Hall